

4756

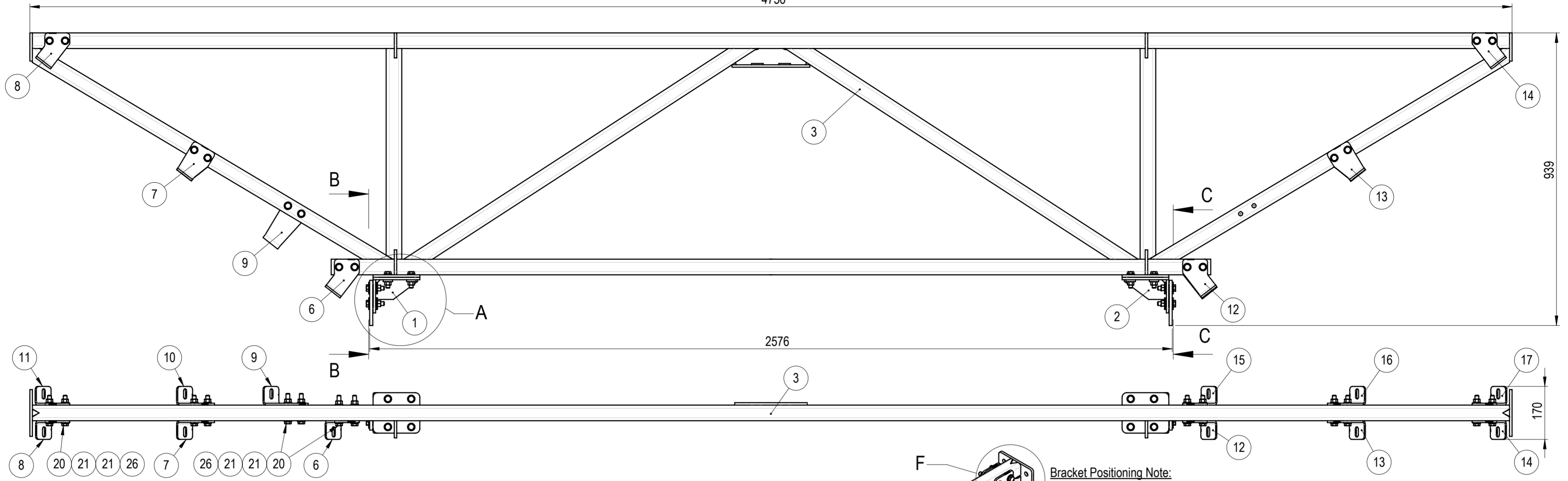

A
SCALE: 1 : 5

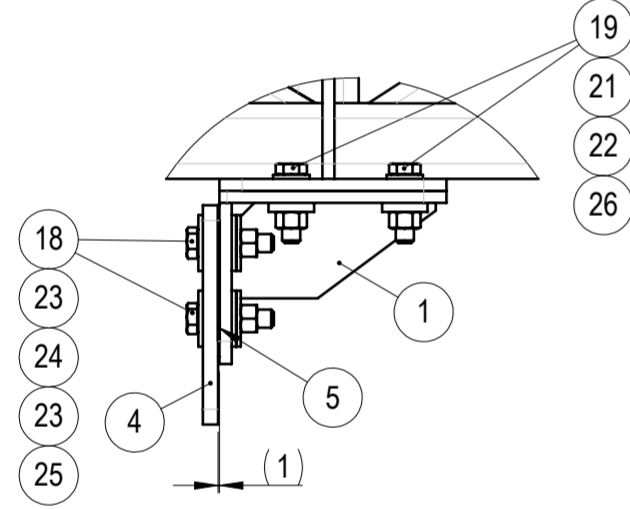

B-B
SCALE: 1 : 5

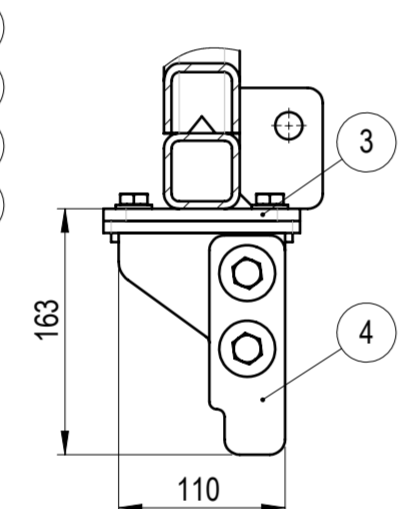

C-C
SCALE: 1 : 5

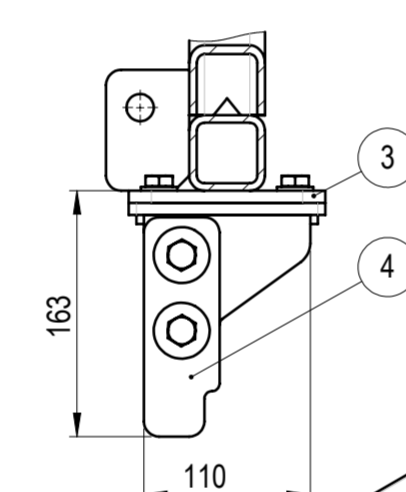

D
SCALE: 1 : 5

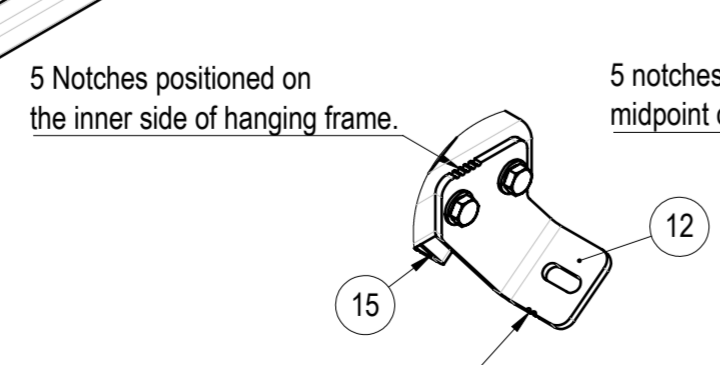

E
SCALE: 1 : 5

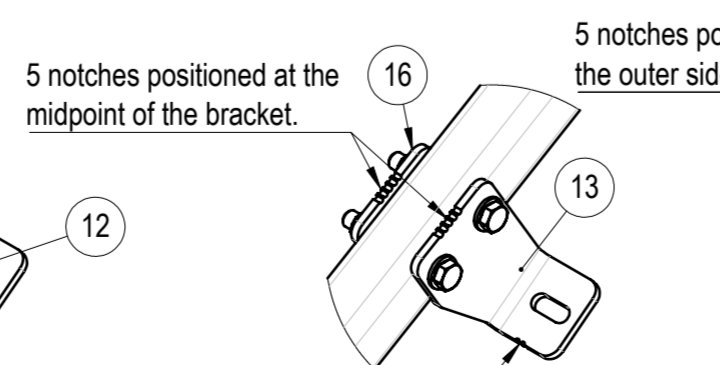

F
SCALE: 1 : 5

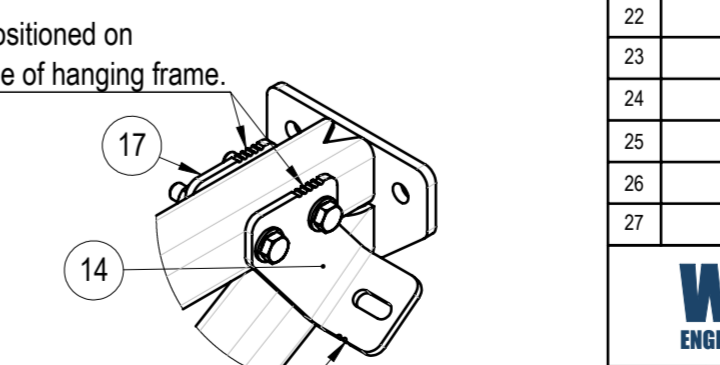

Bracket Positioning Note:

- Brackets 6, 7, 8, 9, 10, 11, 12, 13, 14, 15, 16 & 17 have notches for correct positioning.
- Bottom brackets have a notch located near the center of the hanging frame.
- Middle brackets have a notch positioned in the middle of the bracket.
- Top brackets have a notch on the outer side of the hanging frame center.
- Refer to detail views F, E, and F for notch positioning of right-side brackets.
- The notch positions for left-side brackets are identical in function and placement. The only difference is at the bracket foot: left brackets have 1 identification notch, whereas right brackets have 2 identification notches.

Fastening Note:

- For all fasteners, apply Loctite 243 during final assembly.

NO.	PART NO	DESCRIPTION	MATERIAL	PROCESSING	REVISION	WEIGHT	QTY
1	105-09217-00	Hanging frame bracket 2	-	WLD HDG		2.01	1
2	105-09218-00	Hanging frame bracket 3	-	WLD HDG		2.01	1
3	105-09225-00	Hanging frame weldment 5	-	WLD HDG		96.62	1
4	105-09100-01	Glass holding plate	AISI 304	LC		0.51	2
5	105-09100-02	Plastic shimplate 1mm	POM / black	MCH		0.01	2
6	105-09100-51	Left bracket 9L	S355J2	LCB HDG		0.49	1
7	105-09100-52	Left bracket 9M	S355J2	LCB HDG		0.49	1
8	105-09100-53	Left bracket 9U	S355J2	LCB HDG		0.46	1
9	105-09100-54	Left bracket 10L	S355J2	LCB HDG		0.64	1
10	105-09100-55	Left bracket 10M	S355J2	LCB HDG		0.49	1
11	105-09100-56	Left bracket 10U	S355J2	LCB HDG		0.47	1
12	105-09100-57	Right bracket 9L	S355J2	LCB HDG		0.49	1
13	105-09100-58	Right bracket 9M	S355J2	LCB HDG		0.49	1
14	105-09100-59	Right bracket 9U	S355J2	LCB HDG		0.46	1
15	105-09100-60	Right bracket 10L	S355J2	LCB HDG		0.50	1
16	105-09100-61	Right bracket 10M	S355J2	LCB HDG		0.50	1
17	105-09100-62	Right bracket 10U	S355J2	LCB HDG		0.47	1
18	ISO4017 (DIN933) M12x50	Hex bolt	A2-70	COTS		0.06	4
19	ISO4017 (DIN933) M12x45	Hex bolt	HDG-8.8	COTS		0.06	8
20	ISO4017 (DIN933) M12x90	Hex bolt	HDG-8.8	COTS		0.10	14
21	ISO7089 (DIN125) M12	Plain Washer	HDG-HV200	COTS		0.01	36
22	DIN7349 M12	Thick washer	HDG-HV200	COTS		0.03	8
23	ISO7093 (DIN9021) M12	Large plain washer	A2-HV200	COTS		0.02	8
24	ISO7093 (DIN9021) M12	Large plain washer	Nylon	COTS		0.00	4
25	ISO4032 (DIN934) M12	Hex nut	A2-70	COTS		0.02	4
26	ISO4032 (DIN934) M12	Hex nut	HDG-8	COTS		0.02	22
27	Loctite 243	Threadlocking adhesive medium strength 3ml	-	COTS		0.00	1

Ensure that hanging frame 3 is oriented so the open side faces the viewer.
From this viewpoint, left-hand brackets must be on the left and right-hand brackets on the right!

WEMPS ENGINEERING SERVICES

MATERIAL: 110.712 Kg
SURFACE PROTECTION: MACHINING: ISO 2768 mK
DEBURR AND BREAK SHARP EDGES: DO NOT SCALE DRAWING
THERMAL CUTTING: ISO 9013 221
WELDING: ISO 13920 BF

REVISION: 11.05.2026
SCALE: 1:10
FORMAT: A2

NAME: D. Dislers
SIGNATURE: [Signature]
PART NO: 105-09215-00
DESCRIPTION: Hanging frame assembly 5

SHEET 1/1